

© 2022 ANDY'S BEST CAD. ALL RIGHTS RESERVED. THIS DRAWING IS THE PROPERTY OF ANDY'S BEST CAD AND IS PROTECTED BY COPYRIGHT LAWS OF THE UNITED STATES OF AMERICA. ANY UNAUTHORIZED USE OF THE INFORMATION CONTAINED HEREIN OR PART THEREOF IS STRICTLY PROHIBITED. RECEIPT OR POSSESSION THEREOF DOES NOT CONFER OR TRANSFER ANY RIGHT TO MAKE, COPY, MANUFACTURE AND/OR SELL EITHER THE DRAWING OR THE ITEMS SHOWN THEREIN.

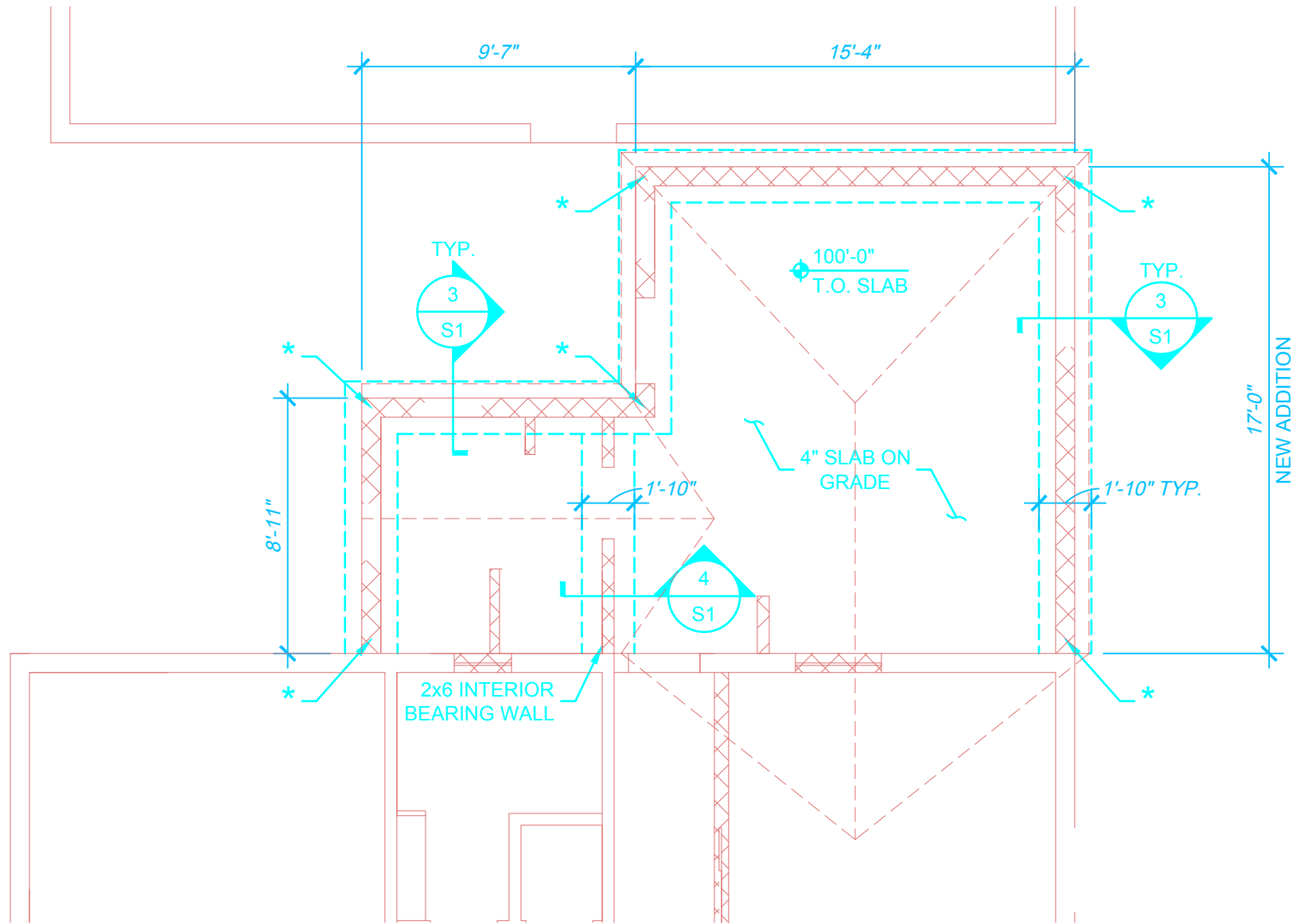
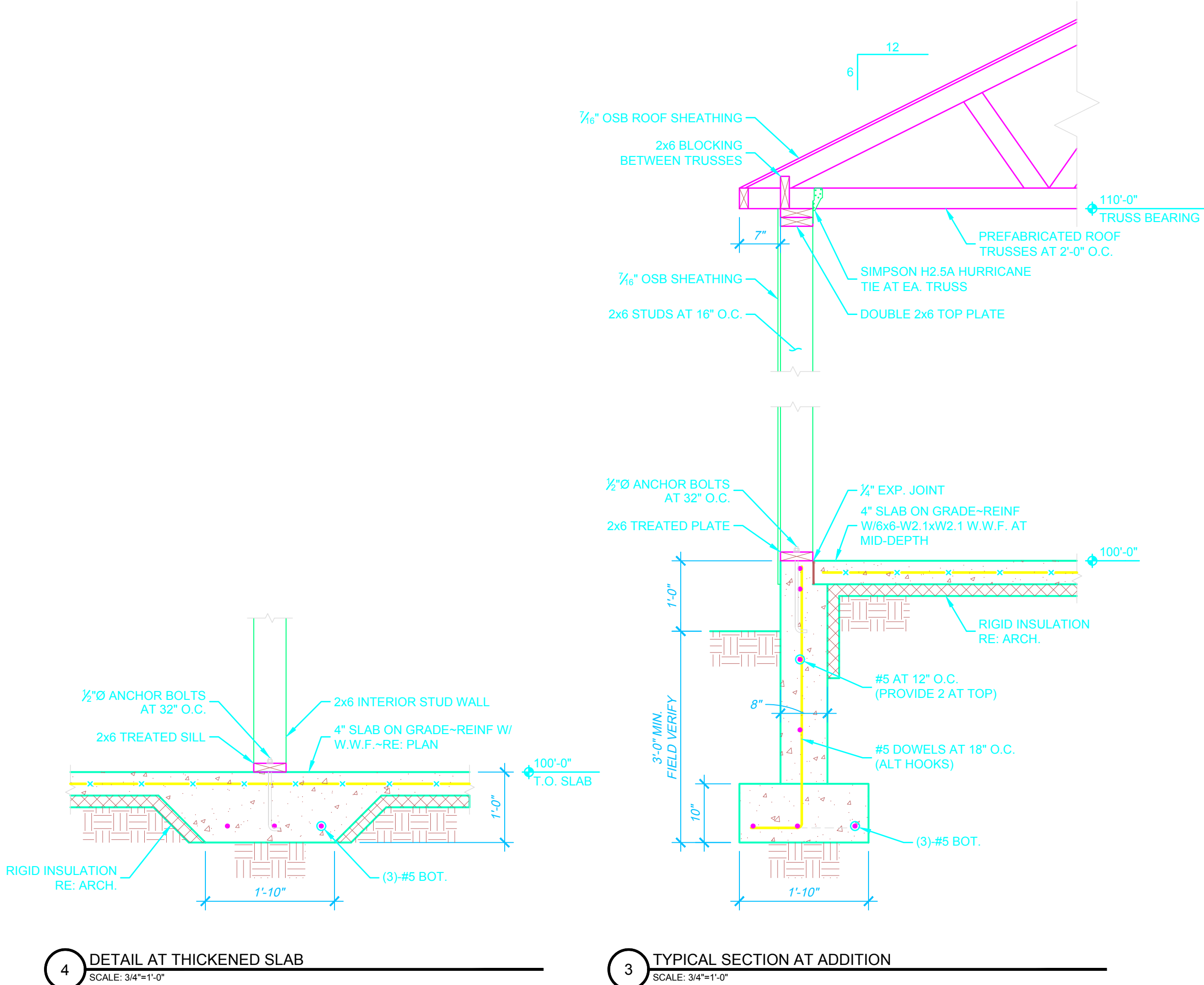

NOTES:

1. NEW FLOOR SLAB SHALL BE 4" NORMAL WEIGHT CONCRETE. REINFORCE SLAB WITH 6x6-W2.1xW2.1 W.W.F. AT MID-DEPTH.
2. TOP OF SLAB SHALL BE ELEVATION 100'-0".
3. SEE FRAMING NOTES FOR ADDITIONAL INFORMATION.
4. * DENOTES LOCATIONS OF SIMPSON H2.5A HOLDOWN WITH (2)-2X6 STUD PACK.

FRAMING NOTES:

1. FRAMING LUMBER: (BASE VALUES FROM 1997 WWSA GRADING RULES)
A. 2X6 SILL PLATES: DOUGLAS FIR-LARCH, STANDARD AND BETTER, F_b = 550 PSI. ALL SILL PLATES TO BE PRESSURE TREATED. PLACE LEVELING GROUT BENEATH ALL SILL PLATES AS REQUIRED. "SILL SEALER" INSULATION TYPE MATERIAL WILL NOT BE ALLOWED.
B. INTERIOR STUDS: 2X4 STUDS TO 8'-0": DOUGLAS FIR-LARCH, STUD GRADE, F_b = 500 PSI, E = 1,400,000 PSI.
C. INTERIOR STUDS: 2X4 STUDS OVER 8'-0": DOUGLAS FIR-LARCH STANDARD AND BETTER, F_b = 675, E = 1,400,000 PSI.
D. STUDS AND OTHER FRAMING 2X6 AND LARGER: DOUGLAS FIR-LARCH, NO. 2 AND BETTER, F_b = 875 PSI, E = 1,600,000 PSI.
2. PROVIDE (3) - 2X6 HEADER OVER ALL EXTERIOR DOOR AND WINDOW OPENINGS UNLESS OTHERWISE NOTED.
3. PROVIDE A MINIMUM OF (2) - 2X6 TRIMMER STUDS AND (1) - 2X6 KING STUDS AT EACH END OF HEADERS UNLESS OTHERWISE NOTED.
4. PLYWOOD SHALL CONFORM TO AMERICAN PLYWOOD ASSOCIATION'S CURRENT PRODUCT STANDARD SPECIFICATIONS AND SHALL BE PERFORMANCE RATED BY THE AMERICAN PLYWOOD ASSOCIATION TO THE GRADES SPECIFIED.
5. ROOF SHEATHING SHALL BE 7/16" APA 24/16 EXPOSURE I RATED PLYWOOD OR OSB. PROVIDE 10D NAILS AT 4" O.C. ALONG PANEL EDGES AND AT 12" ALONG INTERMEDIATE SUPPORTS.
6. EXTERIOR WALLS SHALL BE SHEATHED WITH 7/16" EXPOSURE I PLYWOOD OR OSB SHEATHING NAILED WITH 10D NAILS AT 4" ON CENTER ALONG PANEL EDGES AND 12" O.C. AT INTERMEDIATE SUPPORTS. ALL PANEL EDGES TO BE BLOCKED.
7. METAL CONNECTORS TO BE "SIMPSON STRONG-TIE" OR APPROVED EQUAL. USE FRAMING ANCHORS OR HANGERS FOR ALL CONNECTIONS. TOE NAIL CONNECTIONS ARE NOT ALLOWED.
8. ALL TRUSSES AND ROOF RAFTERS TO BE TIED TO ALL BEARING POINTS WITH ONE SIMPSON H2.5A HURRICANE CLIP OR EQUAL.
9. PREFABRICATED WOOD TRUSSES SHALL BE DESIGNED TO STRESS REQUIREMENTS AND/OR LOADS NOTED ON DRAWINGS. SHOP DRAWINGS SHALL INCLUDE CALCULATIONS AND BEAR THE STAMP OF A REGISTERED ENGINEER IN THE STATE OF COLORADO. PROVIDE BRIDGING AND BLOCKING PER MANUFACTURER'S RECOMMENDATIONS.
10. FASTEN ALL WOOD MEMBERS WITH COMMON NAILS ACCORDING TO THE IBC SCHEDULE TABLE 2304-9.1.
11. PROVIDE 1/2" DIA. X 12" LONG A307 ANCHOR BOLTS AT 32" ON CENTER MAXIMUM SPACING. EMBED MINIMUM 9" INTO CONCRETE. PROVIDE MIN. OF 2 BOLTS PER SILL PLATE PIECE. LOCATE ONE BOLT WITHIN 12" OF EACH END OF EACH SILL PLATE PIECE.

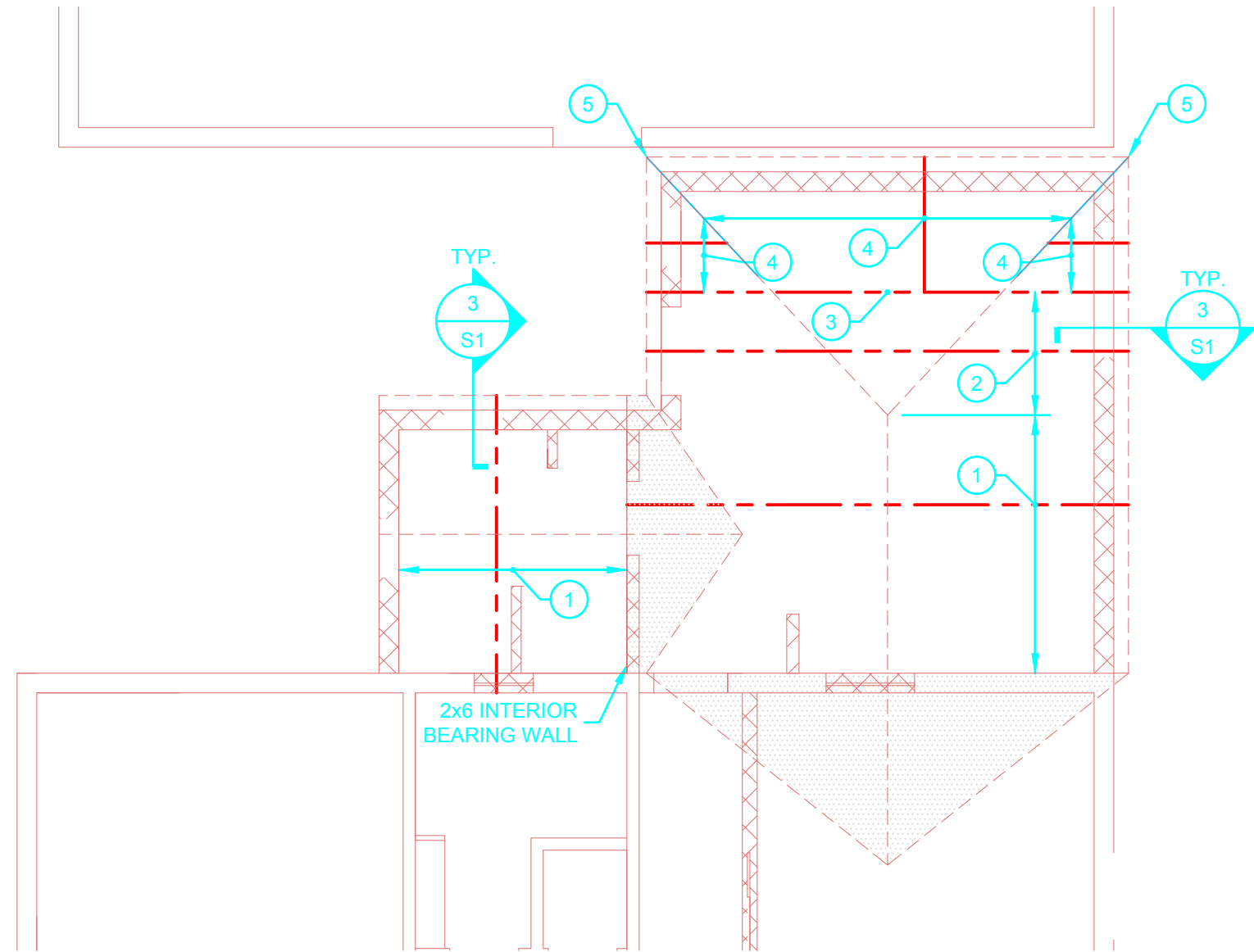

NOTES:

1. TRUSS BEARING ELEVATION SHALL BE 110'-0" U.N.O.
2. (X) DENOTES PREFABRICATED TRUSS TYPE. SEE PLAN AND SCHEDULE.
3. (Hatched Area) DENOTES AREA TO BE OVERFRAMED. OVERFRAMING SHALL BE 2x6 RAFTERS AT 24" O.C. POST DOWN AS REQUIRED W/2x4 FRAMING.
4. ROOF SHEATHING SHALL BE 7/16" OSB WITH A SPAN RATING OF 24/16.
5. SEE FRAMING NOTES FOR ADDITIONAL INFO.

PREFABRICATED TRUSS SCHEDULE

MARK	DESCRIPTION	SPACING	REMARKS
1	COMMON TRUSS	24" O.C.	
2	STEP-DOWN TRUSS	24" O.C.	
3	STEP-DOWN TRUSS GIRDER	N.A.	
4	COMMON JACKS	24" O.C.	
5	HIP TRUSS GIRDER	N.A.	

NOTES:

1. TRUSSES SHALL BE DESIGNED FOR THE INDICATED DESIGN LOADS AND SPANS AND STAMPED BY A PROFESSIONAL ENGINEER REGISTERED IN THE STATE OF COLORADO.
2. TRUSS DESIGN LOADS:
A. TOP CHORD SNOW LOAD.....30 PSF
B. TOP CHORD DEAD LOAD.....10 PSF
C. BOT. CHORD DEAD LOAD.....10 PSF
3. ALL TRUSS TO TRUSS CONNECTIONS AND BRIDGING SHALL BE DESIGNED AND PROVIDED BY TRUSS MANUFACTURER.

DRAWING TITLE:

PROJECT:

REVISION DESCRIPTION:

DATE:

RESIDENTIAL ADDITION
STRUCTURAL
CONSTRUCTION DRAWINGS

DRAWN: ABC
DESIGNED:
CLIENT: 03/02/22
DATE: AS SHOWN
SCALE:

STRUCTURAL PLAN AND DETAILS

DO NOT SCALE DRAWINGS. ALL
DIMENSIONS IN FT & IN
UNLESS NOTED OTHERWISE.

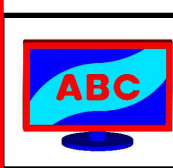

DRAWING NO:
S101
of