

©2014 ANDY'S BEST CAD. ALL RIGHTS RESERVED. THIS DRAWING IS THE PROPERTY OF ANDY'S BEST CAD AND IS PROTECTED BY COPYRIGHT LAWS OF THE UNITED STATES OF AMERICA. ANY UNAUTHORIZED USE OF THE INFORMATION CONTAINED HEREIN OR PART THEREOF IS STRICTLY PROHIBITED. RECEIPT OR POSSESSION THEREOF DOES NOT CONVEY OR TRANSFER ANY RIGHT TO MAKE, COPY, MANUFACTURE AND/OR SELL EITHER THE DRAWING OR THE ITEMS SHOWN THEREIN.

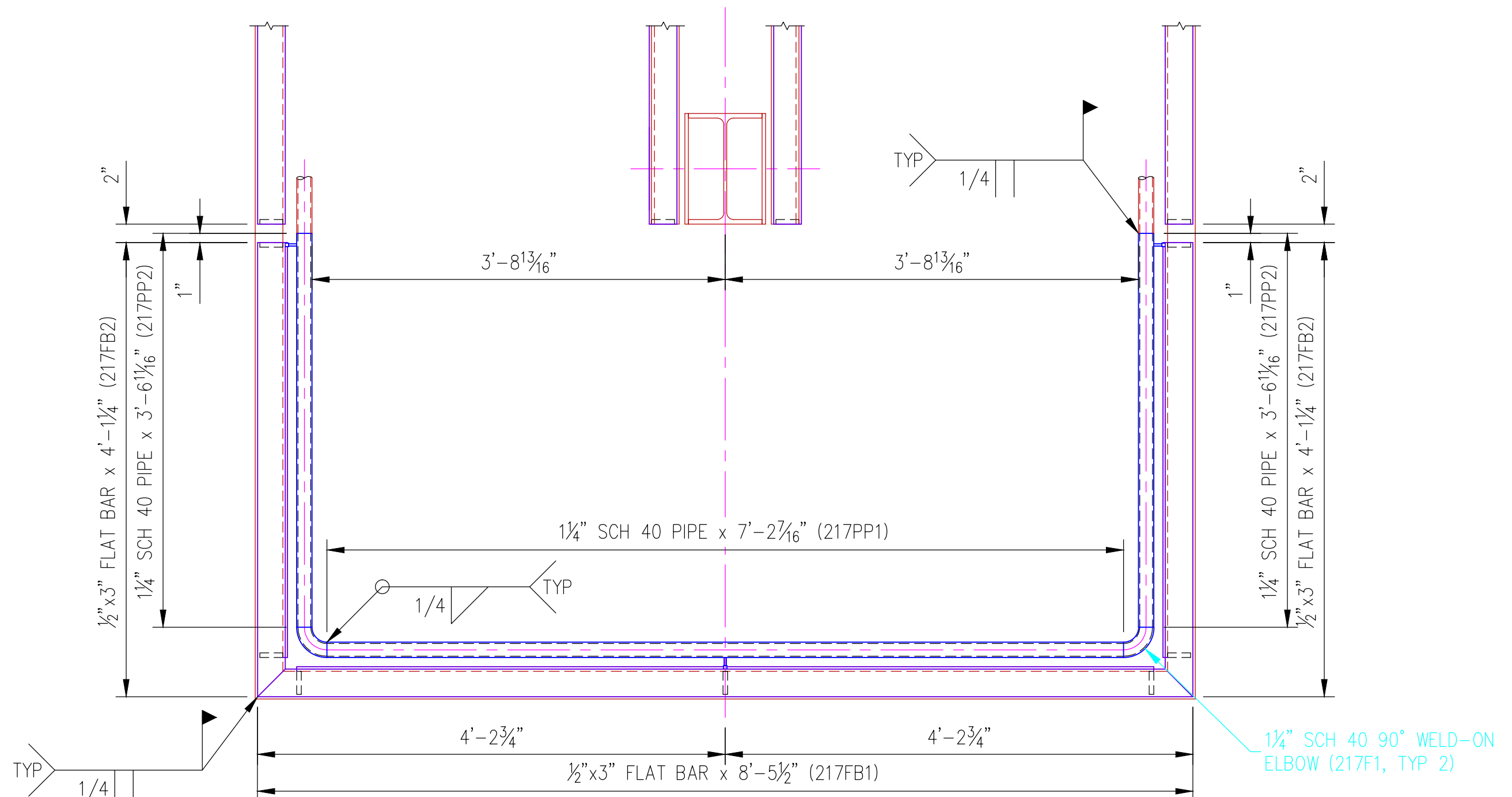

PLAN
LANDING STRUCTURE SHOWN FOR REFERENCE

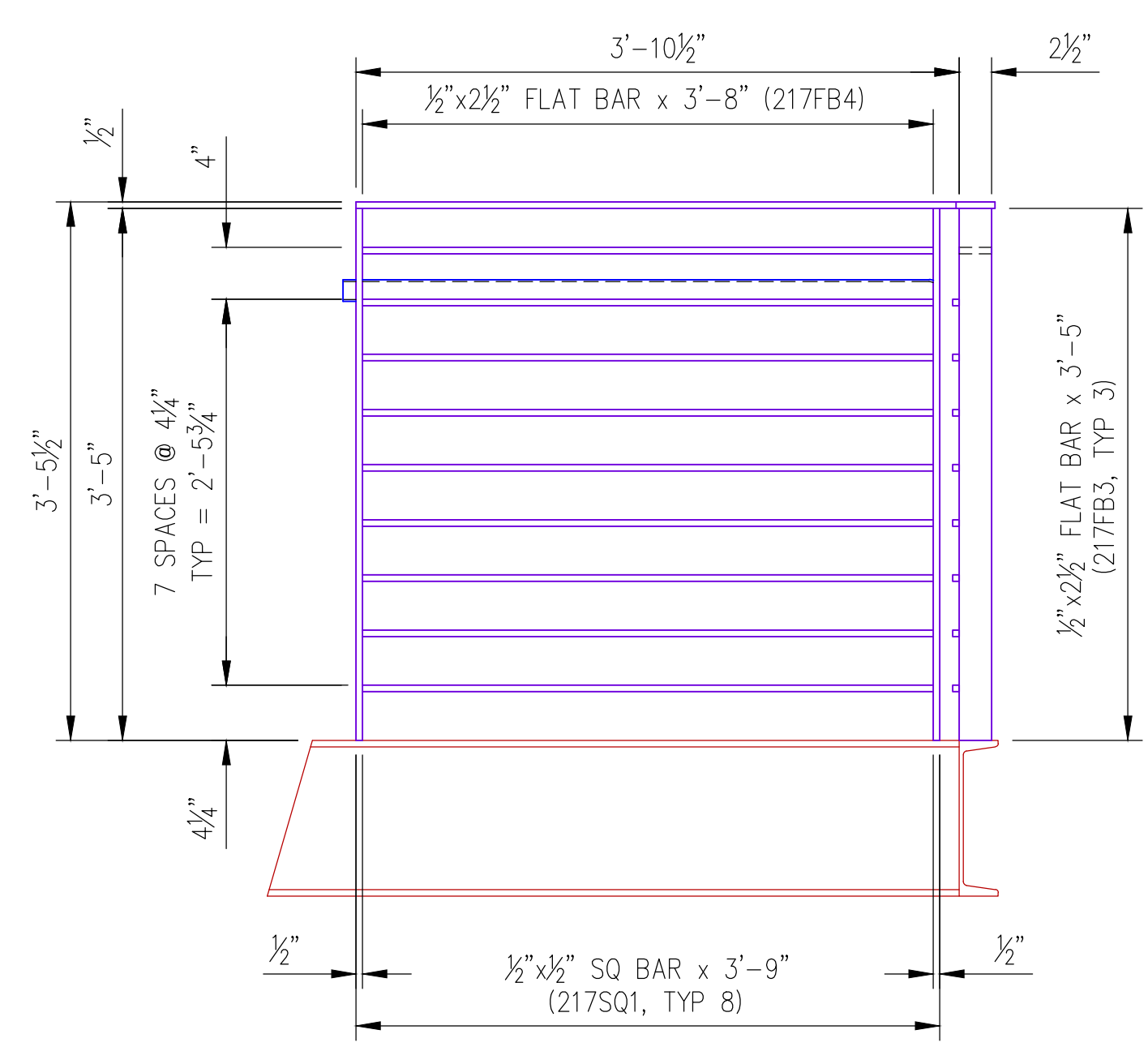

A-A

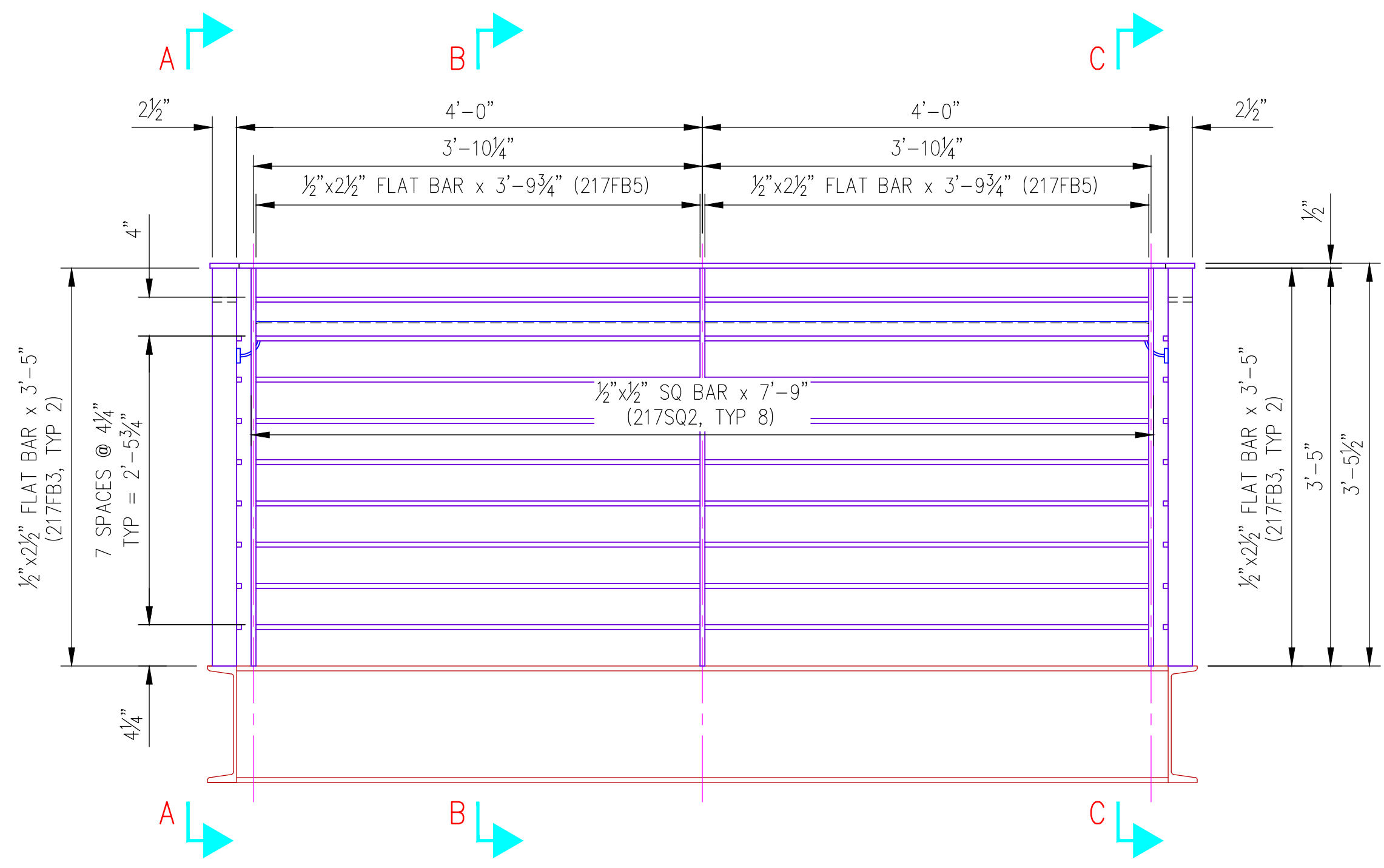

ELEVATION
LANDING STRUCTURE SHOWN FOR REFERENCE

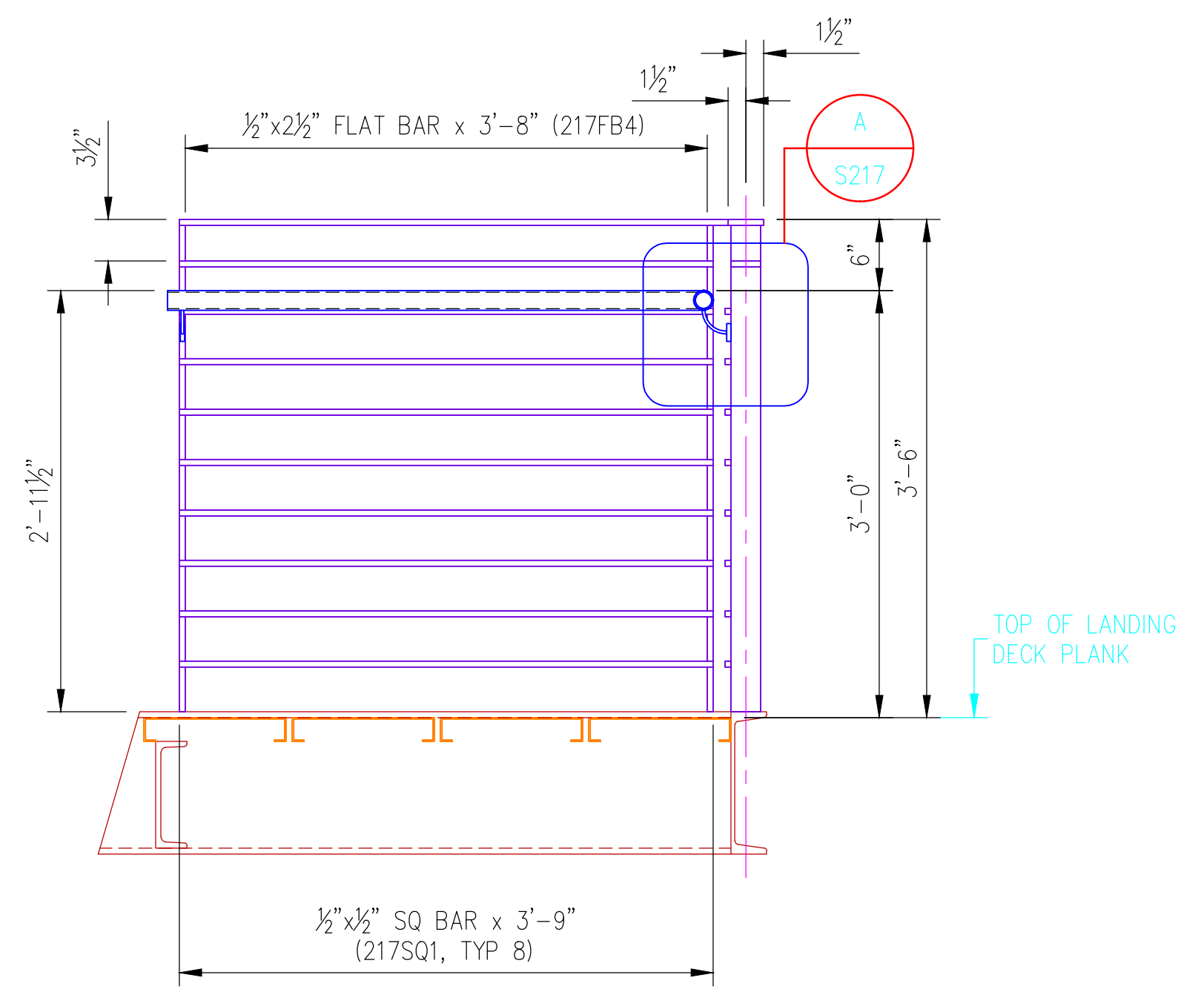

C-C

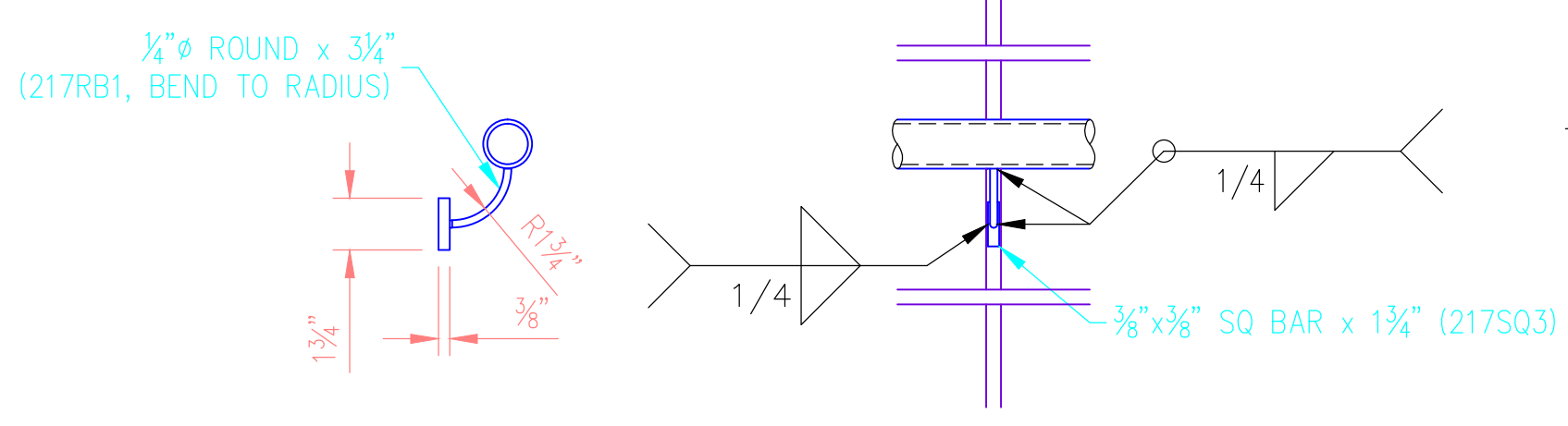

A
HANDRAIL BRACKET

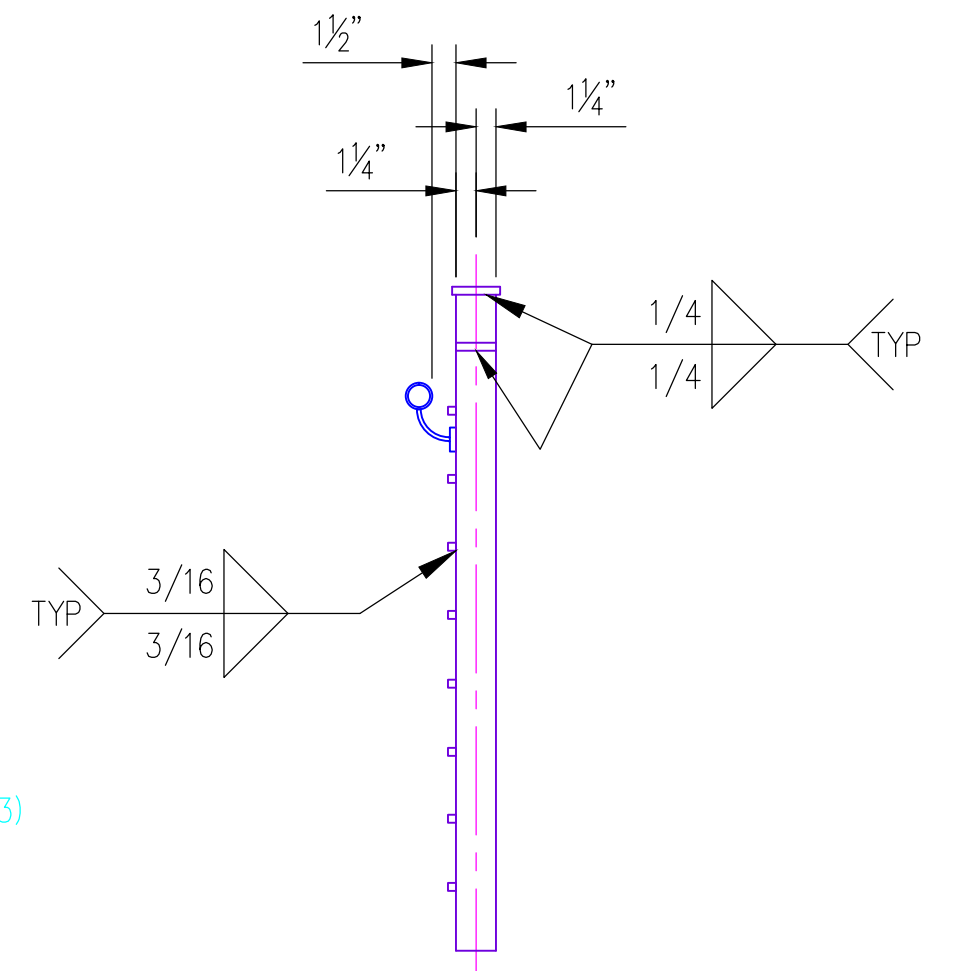

RAILING SECTION
(TYP ALL RAILINGS)

BILL OF MATERIAL

MARK	QTY	DESCRIPTION	FT	IN	REMARKS
ILR-LVL123	3	INTERMEDIATE LANDING RAILINGS-LEVELS 1,2,3			
217FB1	3	1/2" x 3" FLAT BAR	8	5 1/2	
217FB2	6	1/2" x 3" FLAT BAR	4	1 1/4	
217FB3	21	1/2" x 2 1/2" FLAT BAR	3	5	
217FB4	6	1/2" x 2 1/2" FLAT BAR	3	8	
217FB5	6	1/2" x 2 1/2" FLAT BAR	3	9 3/4	
217SQ1	48	1/2" x 1/2" SQUARE BAR	3	9	
217SQ2	24	1/2" x 1/2" SQUARE BAR	7	9	
217PP1	3	1 1/4" SCH 40 PIPE	7	2 1/6	
217PP2	6	1 1/4" SCH 40 PIPE	3	6 1/6	
217SQ3	21	3/8" x 3/8" SQUARE BAR	0	1 3/4	
217RB1	21	1/4" Ø ROUND BAR	0	3 1/4	
217F1	6	1 1/4" SCH 40 90° ELBOW	-	-	WELD-ON

ALL SIZES SHOWN ARE FOR FINISHED MATERIALS

NOT FOR
CONSTRUCTION-FOR
CLIENT REVIEW ONLY
08/22/14

MATERIAL, COATING & FABRICATION SPECIFICATIONS

MATERIALS & FABRICATION	COATINGS
ROLLED W SHAPES: ASTM A992	STEEL STAIR STRINGERS, LANDINGS, VERTICAL COLUMN, STAIR GUARDS, HANDRAILS, RAILINGS AND MISCELLANEOUS STEEL SHALL BE HOT-DIP GALVANIZED AFTER FABRICATION PER ASTM A123.
ROLLED CHANNELS, ANGLES, S, ST, M, HP AND WT SHAPES: ASTM A36	STAIR TREADS AND LANDING DECK PLANKS SHALL BE PRE-GALVANIZED. SURFACES IN CONTACT WITH CONCRETE SHALL NOT BE COATED.
HSS TUBES: ASTM A500, GR. B	
PLATES AND BARS: ASTM A36	
PIPES: ASTM A53, GR. B, SCH. 40, BLACK	
FASTENERS: ASTM 325N	
SURFACE PREP: SSPC-SP2	
WELDING MATERIALS: AWS D1.1 (E70XX-LOW HYDROGEN ELECTRODES)	DO NOT SCALE DRAWINGS. ALL DIMENSIONS IN FT & IN UNLESS NOTED OTHERWISE.

DATE: _____

REV# REVISION DESCRIPTION: _____

DRAWN: ABC
DESIGNED: -
CLIENT: -
DATE: 08/22/14
SCALE: 1"=1'-0"

PROJECT NAME: EXTERIOR STAIRS/STAIR 2
PROJECT ADDRESS: SHOP DRAWINGS

PROJECT: INTERMEDIATE LANDING RAILINGS LEVELS 1, 2, 3

DRAWING NO.: S217
OF