

©2009 ANDY'S BEST CAD. ALL RIGHTS RESERVED. THIS DRAWING IS THE PROPERTY OF ANDY'S BEST CAD AND IS PROTECTED BY COPYRIGHT LAWS OF THE UNITED STATES OF AMERICA. ANY UNAUTHORIZED USE OF THE INFORMATION CONTAINED HEREIN OR PART THEREOF IS STRICTLY PROHIBITED. RECEIPT OR POSSESSION THEREOF DOES NOT CONVEY OR TRANSFER ANY RIGHT TO MAKE COPY, MANUFACTURE AND/OR SELL EITHER THE DRAWING OR THE ITEMS SHOWN THEREIN.

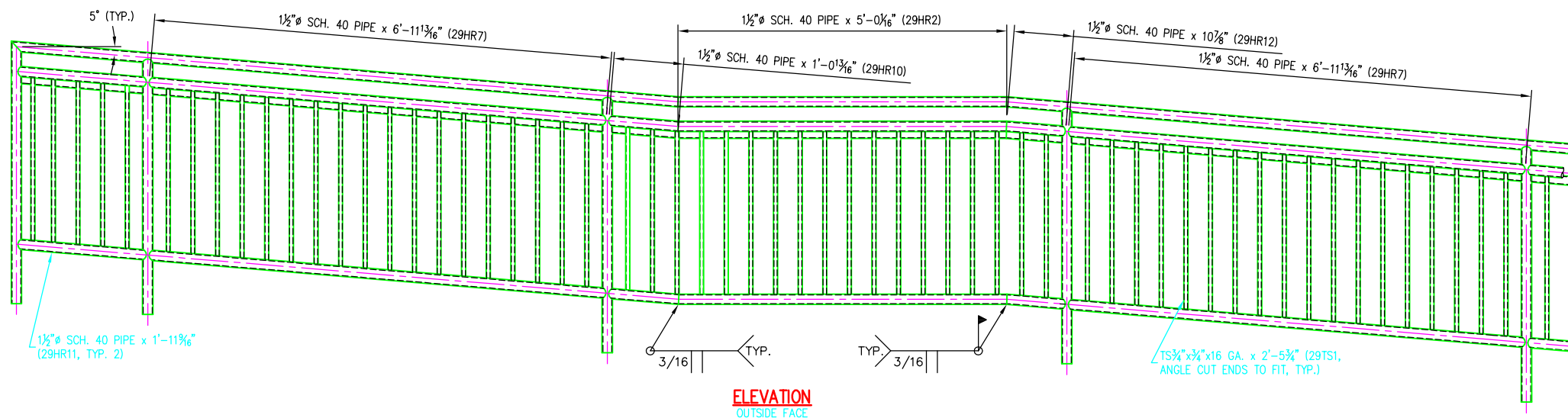

ELEVATION
OUTSIDE FACE

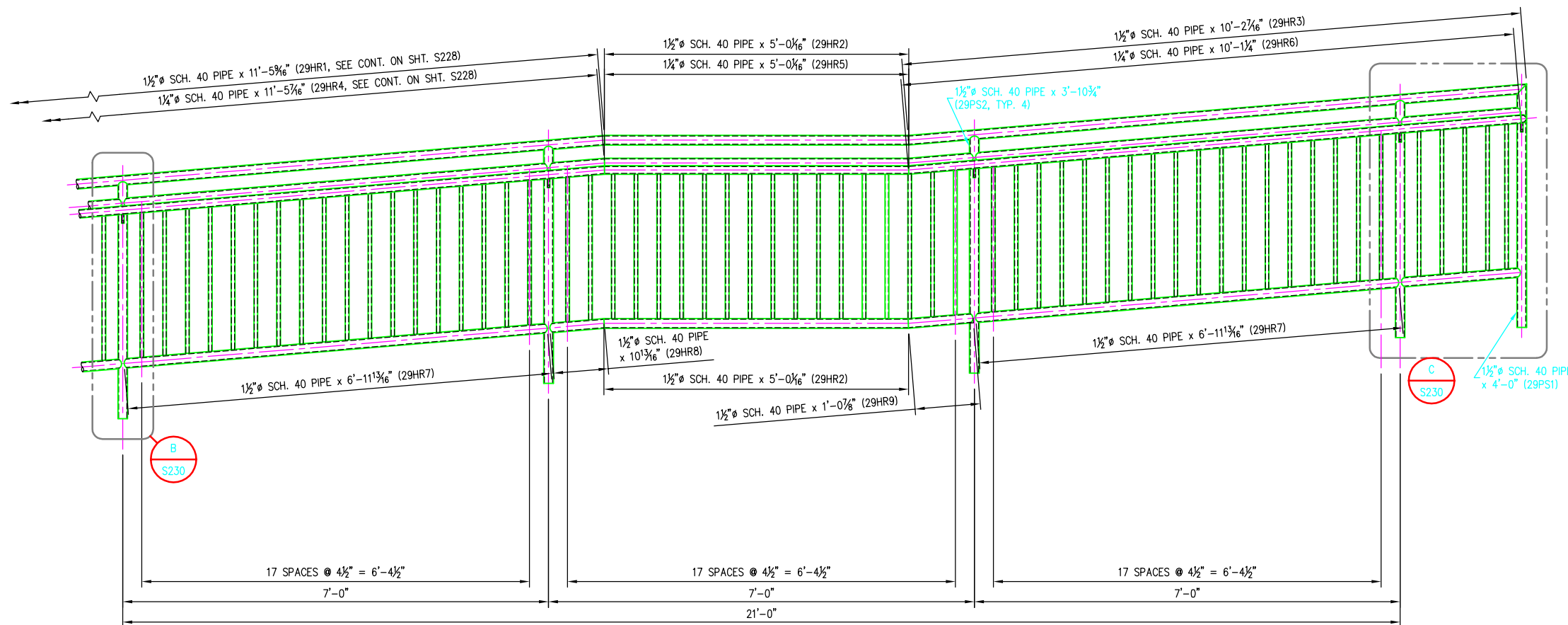

ELEVATION
INSIDE FACE

29RTL3

(1) RAILING TYPE L3-UPPER RAMP
RE: SHT. A4.02, SECT. 4
RE: SHT. A3.41, DETAIL 11

BILL OF MATERIAL

MARK	QTY	DESCRIPTION	FT	IN	REMARKS
29RTL3	1	RAILING TYPE L3-UPPER RAMP			
29HR1	1	1 1/2" SCH. 40 PIPE	11	5 3/16"	
29HR2	3	1 1/2" SCH. 40 PIPE	5	0 5/16"	
29HR3	1	1 1/2" SCH. 40 PIPE	10	2 1/16"	
29HR4	1	1 1/2" SCH. 40 PIPE	11	5 1/16"	
29HR5	1	1 1/2" SCH. 40 PIPE	5	0 5/16"	
29HR6	1	1 1/2" SCH. 40 PIPE	10	1 1/2"	
29HR7	4	1 1/2" SCH. 40 PIPE	7	0 5/16"	
29HR8	1	1 1/2" SCH. 40 PIPE	0	11 1/16"	
29HR9	1	1 1/2" SCH. 40 PIPE	1	1 1/8"	
29HR10	1	1 1/2" SCH. 40 PIPE	1	1 1/16"	
29HR11	2	1 1/2" SCH. 40 PIPE	1	11 1/16"	
29HR12	1	1 1/2" SCH. 40 PIPE	0	11 1/16"	
29PS1	1	1 1/2" SCH. 40 PIPE	4	0 1/4"	
29PS2	4	1 1/2" SCH. 40 PIPE	3	11	
29TS1	59	TS 3/4" x 3/4" x 16 GA.	2	6	

DATE:

REV:	REVISION DESCRIPTION:

ANDY'S BEST CAD
9715 S. MERIBULA ST.
LITTLETON, CO 80130
303-791-1622
WWW.ANDYSBESTCAD.COM

DRAWN: A.LANDT
DESIGNED: A.LANDT
CLIENT: 05/04/09
DATE: 1"=1'-0"
SCALE:

UNIVERSITY
ATHLETIC STADIUM
STRUCTURAL STEEL
HANDRAILS AND RAILINGS

FABRICATION NOTES

1. REMOVE ALL BURRS FROM EXPOSED CUT EDGES.
2. EASE EXPOSED EDGES TO AN APPROXIMATE 1/2" RADIUS.

MATERIAL, COATING & FABRICATION SPECIFICATIONS

MATERIALS & FABRICATION	COATINGS
ALL TUBE SECTIONS: A500 GR. B	SURFACES EMBEDDED IN CONCRETE SHALL NOT BE PAINTED.
ALL PIPES: A53, GR. B, SCH. 40	SURFACES TO BE FIELD WELDED SHALL NOT BE PAINTED.
PLATES: A36	PRIMER: ONE COAT, MIN. 3.0 MILS DFT, OF TNE MEC, SERIES 90-97 TNE ME-ZINC, ZINC-RICH PRIMER.
WF, WT: A992	INTER. COAT: ONE COAT, MIN. 3.0 MILS DFT, OF TNE MEC, SERIES N69-1255.
OTHER SHAPES: A36	TOP COAT: ONE COAT, MIN. 3.0 MILS DFT, OF TNE MEC, SERIES 1077 ENDURALUME. TOP COAT SHALL BE DU STANDARD COLOR CRANBERRY.
HEADED ANCHOR STUDS: A108	
DEFORMED ANCHOR STUDS: A496	
ALL WELDING: AWS D1.1, E70 ELECTRODES	
SURFACE PREP: SSPC-SP10	

DRAWING TITLE:
**RAILING L3
TYPE L3
UPPER RAMP**

DRAWING NO.:
S229
OF

